

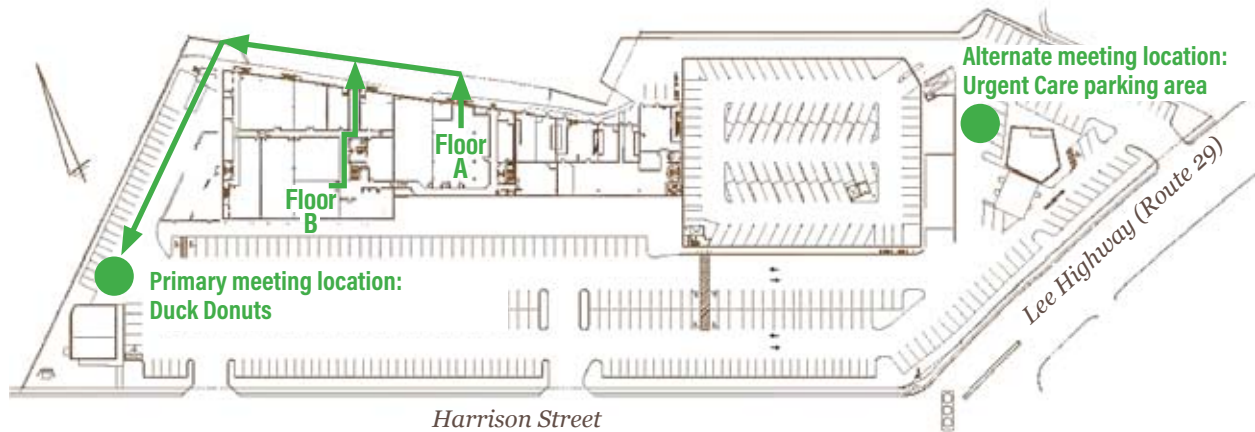

jhoon rhee taekwon do

Evacuation Procedure



1. All students are to line up in single file at the exit.

- Floor A: the exit is the door off the mats at the back of the school.
- Floor B: the exit is the double doors past *Protea Diamonds*.

2. All students will be escorted by instructors to one of two meeting locations.

- The parking area and/or back side of Duck Donuts is the primary meeting location.
- If that area is not available or accessible, the alternate meeting location is the parking area of the stand alone building of the Urgent Care.